



INSTRUCTION BULLETIN

No. 9008174
Machine: Sentinel
Published: 09-2010
Rev. 00

NOTE: DO NOT DISCARD the Parts List from the Instruction Bulletin. Place the Parts List in the appropriate place in the machine manual for future reference. Retaining the Parts List will make it easier to reorder individual parts and will save the cost of ordering an entire kit.

NOTE: Numbers in parenthesis () are reference numbers for parts listed in Bill of Materials.

Installation instructions for **kit number 9008174**

SYNOPSIS:

This kit contains the parts needed to replace the instrument panel assembly on Sentinel sweepers. Please follow step-by-step instructions.

SPECIAL TOOLS / CONSIDERATIONS: NONE

(Estimated time to complete: 1 hour)

PREPARATION:

1. Park the machine on a clean level surface, turn off the machine, remove the key, and set the parking brake.

FOR SAFETY: Before leaving or servicing machine, stop on level surface, turn off machine, and remove key.

2. Disconnect the battery cables from the battery.



WARNING: Always disconnect battery cables from machine before working on electrical components.

INSTALLATION:

1. Remove the instrument bezel from the instrument shroud. Set aside the pan screws. Refer to Fig. 9.

2. Disconnect the instrument panel ribbon cable from the touch panel. Refer to Fig. 1.

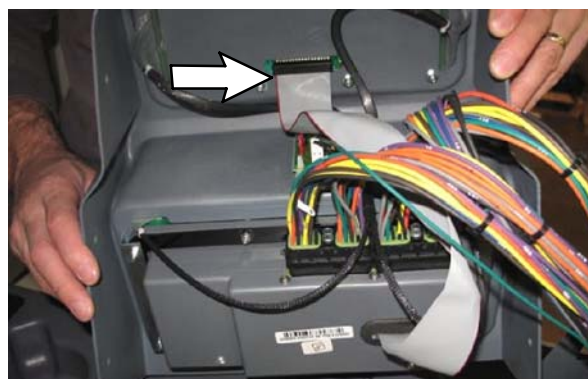

FIG. 1

3. Disconnect the main wire harness from the instrument panel.
4. Disconnect the light connector from the light board. Refer to Fig. 2 and Fig. 9.

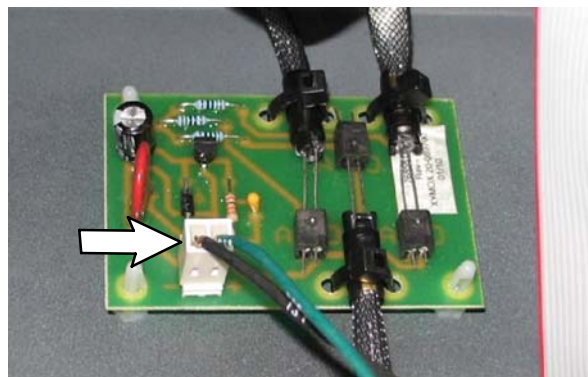

FIG. 2

5. Cut the cable ties and disconnect the three fiber optic cables from the light board. Refer to Fig. 3 and Fig. 9.

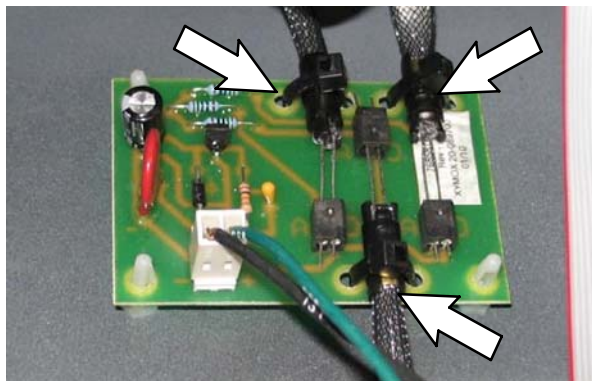

FIG. 3

NOTE: The longer fiber optic connector leads must be positioned into the light board terminals as shown in Fig. 6.

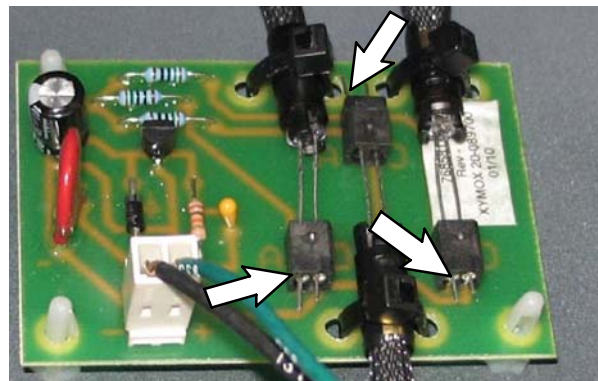

FIG. 6

6. Remove the instrument panel from the instrument bezel. Set instrument panel mounting hardware aside. Refer to Fig. 9.
7. Install the new instrument panel (1) into the instrument bezel. Refer to Fig. 9.
8. Twist and connect the instrument panel (1) ribbon cable to the touch panel. Note location of red tracer on ribbon cable. Refer to Fig. 4.

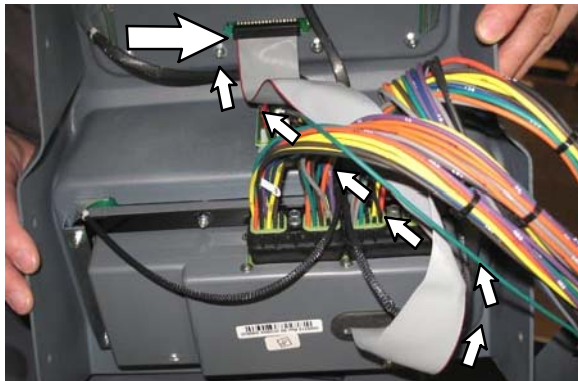

FIG. 4

10. Use a cable tie to secure the fiber optic cable connectors to the light board. Refer to Fig. 5.
11. Connect the light connector to the light board. Refer to Fig. 7 and Fig. 9.

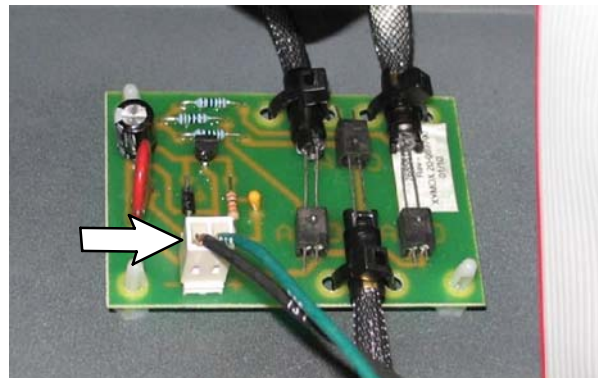

FIG. 7

9. Connect the three fiber optic cables from the instrument panel (1) to the light board. Refer to Fig. 5 and Fig. 9.

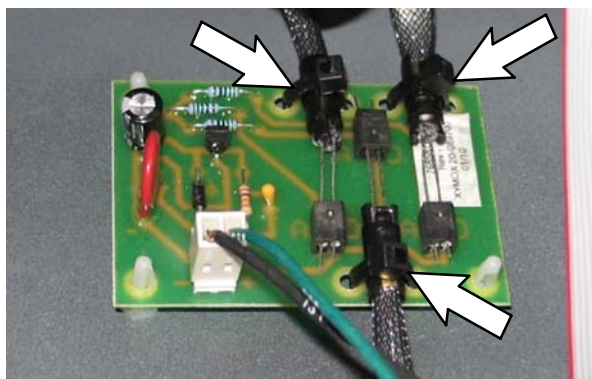

FIG. 5

12. Reinstall the instrument bezel onto the instrument shroud. Refer to Fig. 9.

13. Reconnect the battery cables to the battery.

PROGRAM INSTRUMENT PANEL:

14. With machine not yet started, press the hopper door open button on the touch panel. Refer to Fig. 8.



FIG. 8

15. Continue pressing the hopper door open button and turn the key to the on position, but do not start the machine. Continue to press the hopper door open button for an additional 5 seconds. The instrument panel will display miles and mph (miles per hour). Repeat Step 8 and Step 9 to change the instrument panel to kilometers and kph (kilometers per hour). Refer to Fig. 8.

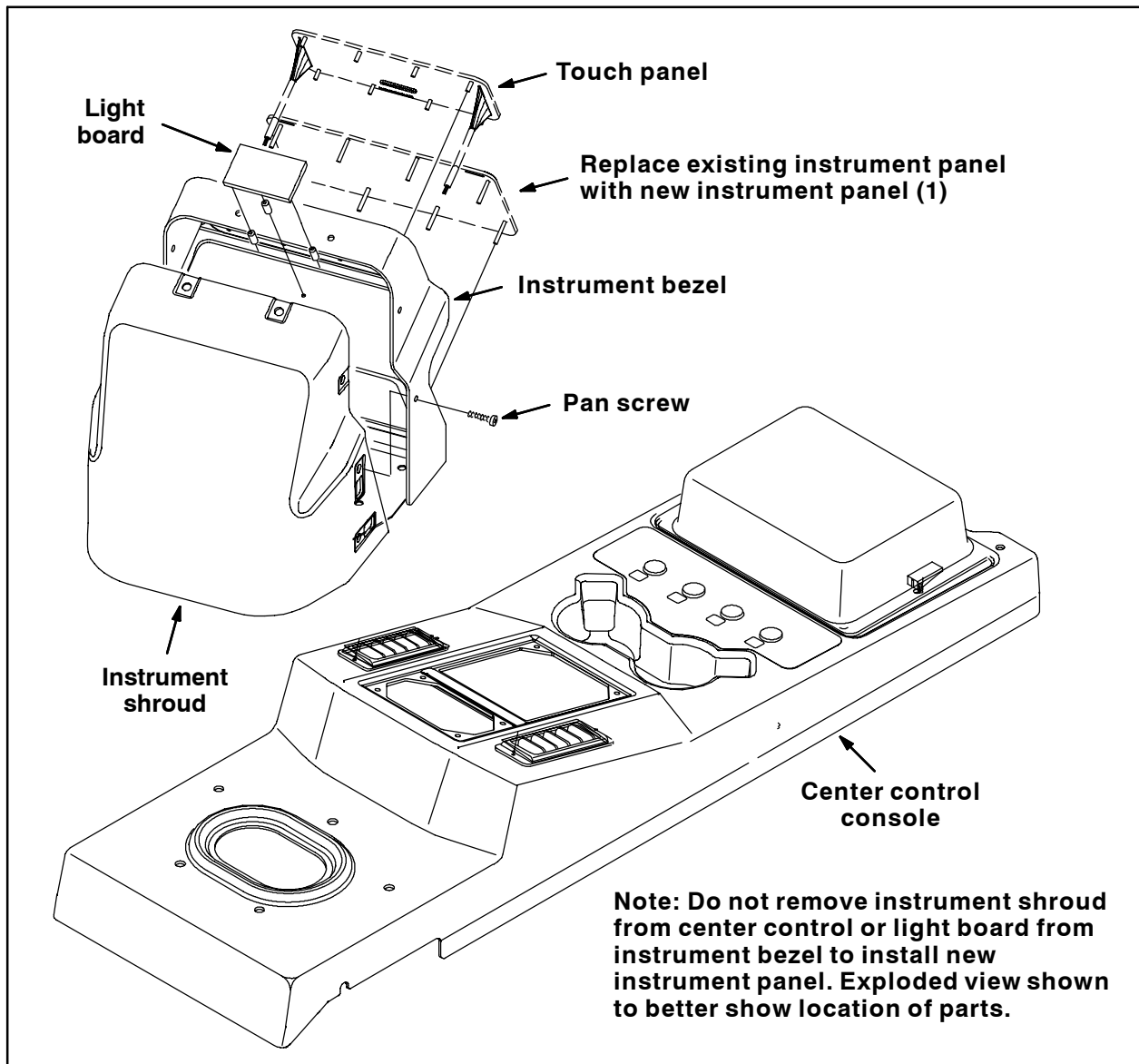

FIG. 9

Bill of Materials for Panel Kit, Instmt, Replmt [Sentinel] - 9008173

Ref.	Tennant Part No.	Description	Qty.
▽	9008173	Panel Kit, Instmt, Replmt [Sentinel]	1
▲ 1	1009314	Panel Assy, Instmt [W/ SW Panl, Sentinel]	1

TENNANT COMPANY
P. O. Box 1452
Minneapolis, MN 55440-1452